

| |
|----------|
| Date |
| Customer |
| Project |
| Type |

M-LED Module 111 1x LED 2700K Medium DE Aluminium Brushed Anodised

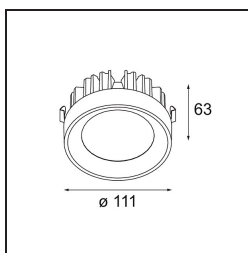

Specifications

| | | | |
|---------------------------------|----------------------------------|------|------|
| Material | 11298124 | | |
| Light Source Type | LED | | |
| LED Type | BRIDGELUX VERO13 | | |
| LED technology | LED COB | | |
| CRI | Min. 90 | | |
| Colour Temperature | 2700K | | |
| Lifetime | L80B20 @50,000 Hours | | |
| Lamp Included | Yes | | |
| Number of Light Sources | 1 | | |
| Binning (SDCM) | 3 | | |
| Optic | Reflector | | |
| Input Voltage | Constant Current Driver Required | | |
| Electrical Class | III | | |
| IP Rating | 20 | | |
| Glow wire rating (°C) | 960 | | |
| Indoor/Outdoor | Indoor | | |
| Adjustability | Not Applicable | | |
| Distance to Lighted Object (m) | 0,1 | | |
| Primary Colour & Primary Finish | Aluminium, Brushed Anodised | | |
| Gross weight (g) | 474.0 | | |
| Drive current (mA) | 350 | 500 | 700 |
| Min. forward voltage (Vf) | 29,1 | 29,9 | 31,0 |
| Max. forward voltage (Vf) | 33,7 | 34,7 | 35,8 |
| Connected load (W) | 11,0 | 16,2 | 23,4 |
| Luminous flux per lamp (lm) | 941 | 1285 | 1662 |
| Efficacy (lm/W) | 86 | 79 | 70 |
| Glare rating | 16 | 17 | 18 |

TM30 & CRI diagram



Light distribution & beam diagram

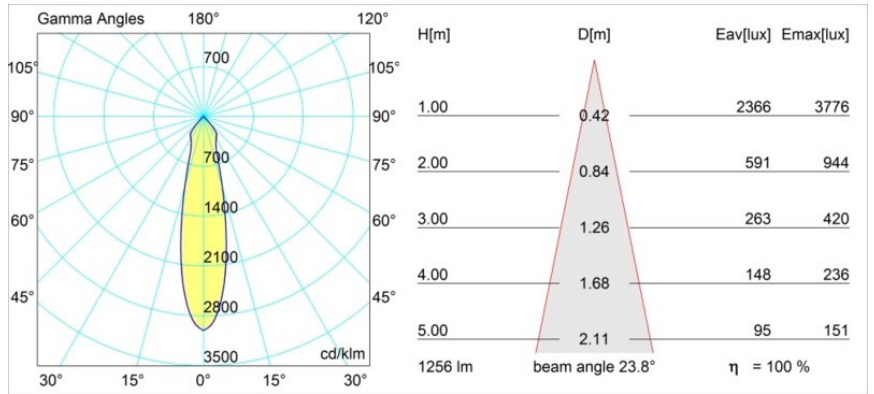

Diagrams